

# INTRODUCTION

# GTE2117: LED POST TOP LIGHT

## FEATURE

Modern Post Top Area Lighting  
 Low-glare Uniform Light Distribution  
 Long Lifespan > 50,000hours  
 Working Temperature: -30°C~50°C

## MAIN MATERIAL

LED Brand: GUBO  
 Driver Brand: GUBO  
 Housing: Die-casted Aluminum  
 Optics: High Efficiency PC Lens  
 Diffuser: Clear Tempered Glass Diffuser

## INSTALLATION

(B/C/D)Mounting: Bollard  
 (E/F/G)Mounting Slip Fitter: W140xT90mm  
 Suitable for Road Light, like Street, Park.....

## STANDARD

Designed and Manufactured to Comply with  
 CE/RoHS/CB/cETL/SAA Standard  
 Withstand Voltage: 3.75KV, Surge: 6KV  
 IP65 Protection, Class I Electric

## OPTION

LED CCT: 1700K/2200K/2700K/3500K/5000K  
 [CRI]: [E] RA80, [G] RA90, [H] RA97  
 [Post]: Height 1M/1.2M/4M/6M  
 [CSL]: Photocell Lux Sensor  
 Custom Housing Finish: Colors by RAL Code

<b>WHITE</b> RAL9010P	<b>BLACK</b> RAL9005P	<b>GREY</b> RAL7042P	<b>DARK GREY</b> RAL7016P
--------------------------	--------------------------	-------------------------	------------------------------

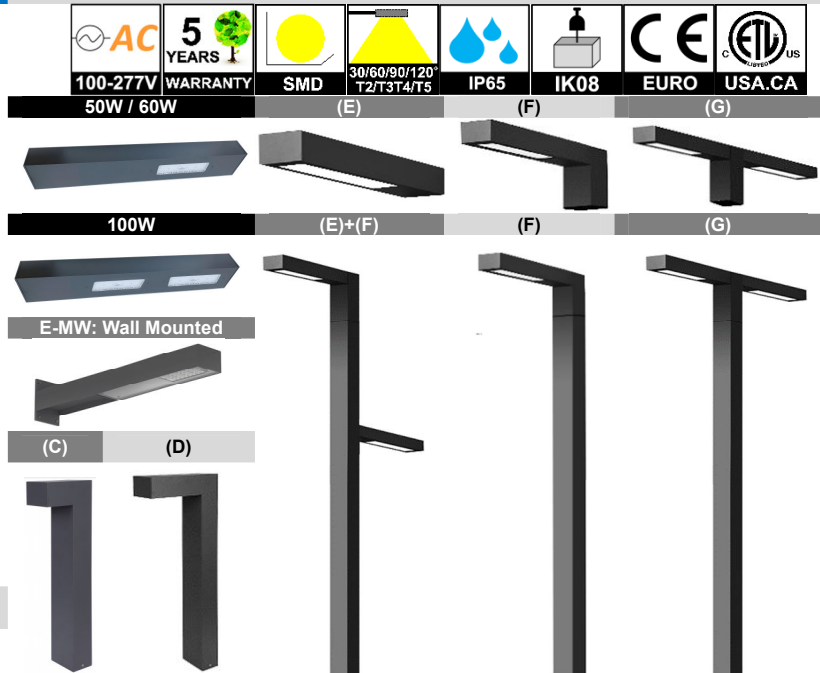

## CASE STUDY:

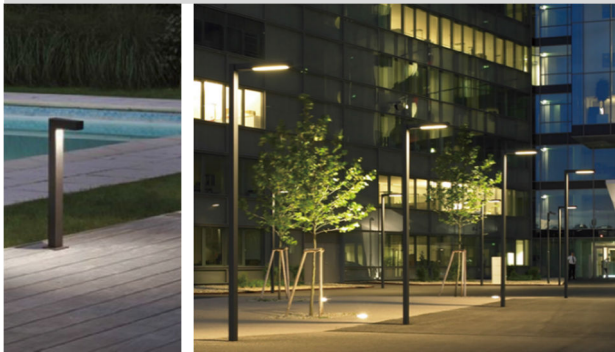

## DIMENSION: [UNIT: MM]

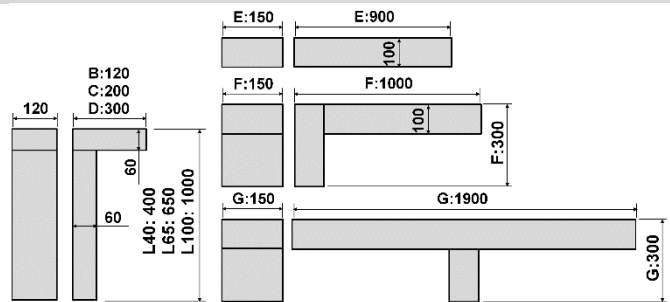

MODEL	POWER [W]	LED TYPE	CCT [K]		CRI	FLUX [LM]	POWER FACTOR	BEAM ANGLE	OPTIONAL DIMMING	INPUT [V]
GTE2117B	12W	24x2W SMD3030	G3000K		RA90	1050	> 0.9	[Asymmetric] T2S: V130xH160° T2M: V90xH150° T3S: V90xH150° T3M: V100xH160° T4S: V130xH150° T4M: V100xH150°	[CDT]:TRIAC(15%) [CDV]:0/1~10V(8%) [CDV0]:0~10V(1%) [CDV1]:1~10V(15%) [CDX]:DMX512(1%) [CDA]:DALI(1%) [CDP]:PWM(1%)	AC100~277V [AC100~240V] [AC180~528V] 50/60Hz
			G4000K		RA90	1140				
			G6500K		RA90	1140				
	2C@12W	TWG	G2700K	G6500K	RA90	520	> 0.5			
	4C@12W	RGBW	620nm 520nm 465nm G2700K	\	520	> 0.4				
4C@12W	RGBA	620nm 520nm 465nm 590nm	\	520	> 0.4					
GTE2117C	20W	36x2W SMD3030	G3000K		RA90	1760	> 0.9			
			G4000K		RA90	1910				
			G6500K		RA90	1910				
	2C@20W	TWG	G2700K	G6500K	RA90	820	> 0.5			
	4C@20W	RGBW	620nm 520nm 465nm G2700K	\	820	> 0.4				
4C@20W	RGBA	620nm 520nm 465nm 590nm	\	820	> 0.4					
GTE2117D	30W	48x2W SMD3030	G3000K		RA90	2460	> 0.9			
			G4000K		RA90	2660				
			G6500K		RA90	2660				
	2C@30W	TWG	G2700K	G6500K	RA90	1250	> 0.5			
	4C@30W	RGBW	620nm 520nm 465nm G2700K	\	1250	> 0.4				
4C@30W	RGBA	620nm 520nm 465nm 590nm	\	1250	> 0.4					
GTE2117E	50W [60W] [100W]	64x2W [2x64x2W] SMD3030	G3000K		RA90	5210	> 0.9	[Symmetric] BL30D:30° BL60D:60° BL90D:90° BL120D:120° T5:150°		
			G4000K		RA90	5970				
			G6500K		RA90	5970				
	2C@50W	TWG	G2700K	G6500K	RA90	2700	> 0.6			
	4C@50W	RGBW	620nm 520nm 465nm G2700K	\	2700	> 0.5				
4C@50W	RGBA	620nm 520nm 465nm 590nm	\	2700	> 0.5					
GTE2117F	50W [60W] [100W]	64x2W [2x64x2W] SMD3030	G3000K		RA90	5210	> 0.9			
			G4000K		RA90	5970				
			G6500K		RA90	5970				
	2C@50W	TWG	G2700K	G6500K	RA90	2700	> 0.6			
	4C@50W	RGBW	620nm 520nm 465nm G2700K	\	2700	> 0.5				
4C@50W	RGBA	620nm 520nm 465nm 590nm	\	2700	> 0.5					
GTE2117G	2x50W [2x60W] [2x100W]	2x64x2W [4x64x2W] SMD3030	G3000K		RA90	2x5210	> 0.9			
			G4000K		RA90	2x5970				
			G6500K		RA90	2x5970				
	2x2C@50W	TWG	G2700K	G6500K	RA90	2x2700	> 0.6			
	2x4C@50W	RGBW	620nm 520nm 465nm G2700K	\	2x2700	> 0.5				
2x4C@50W	RGBA	620nm 520nm 465nm 590nm	\	2x2700	> 0.5					

## NOTE:

All parameters are measured at 25°C ambient temperature, 35% humidity experimental environment.  
 Tolerances of power and luminous flux are ±10%, tolerance of color rendering index is ±5.