

INTRODUCTION

ERMA: LED GARDEN LIGHT

FEATURE

Perfect Luminaires for Driveways and Footpaths
 Pleasantly Uniform Light Effects
 Suitable for Areas Without Risk of Vandalism
 Long Lifespan >50,000hours
 Working Temperature: -30°C~50°C

MAIN MATERIAL

LED Brand: GUBO
 Driver Brand: GUBO
 Housing: Aluminum Profile
 Optics: PC Lens with Clear Glass Diffuser.

INSTALLATION

Suitable for Garden, Park, Plaza.....

- [FFS]: Flush Surface Mounted
 - [FPS]: Stem Pendant
 - [FPC]: Catenary Pendant
 - [FWA]: Wall Surface Mounted
 - [FWH]: Updown Lighting Wall Surface Mounted
 - [FSC]: Slip Fitter Mounted
 - [FJP]: Fixing Plate on JBOX/Outlet Box
 - [PSA]: Aluminum Straight Bollard
- NOTES:** Custom Installation and Accessories Referred to Another Catalogue of Fixing Kits.

STANDARD

Designed and Manufactured to Comply with
 CE/RoHS/TUV/CB/cETL/SAA Standard
 IP65 Protection, Class I Electric

CUSTOM OPTION

LED CCT: 1,600K~10,000K/R/G/B/Y
 [CRI]: [E] RA80, [G] RA90, [H] RA97(RG0)
 [WM40C]: Working Temperature -40°C~50°C
 [SFH]: Custom Housing Finish by RAL Code

White RAL9003P	Black RAL9005P	Anthracite Grey RAL7016P	Dusty Grey RAL7037P	Traffic Grey RAL7042P
White Aluminum RAL9006P	Grey Brown RAL8019P	Telegrey RAL7047P	Graphite Grey RAL7043P	Pearl Grey RAL9022P
Custom Top Profile				
[MTF] Flat Top	[MTD] Dome Top	[MTT] Tilt Top		

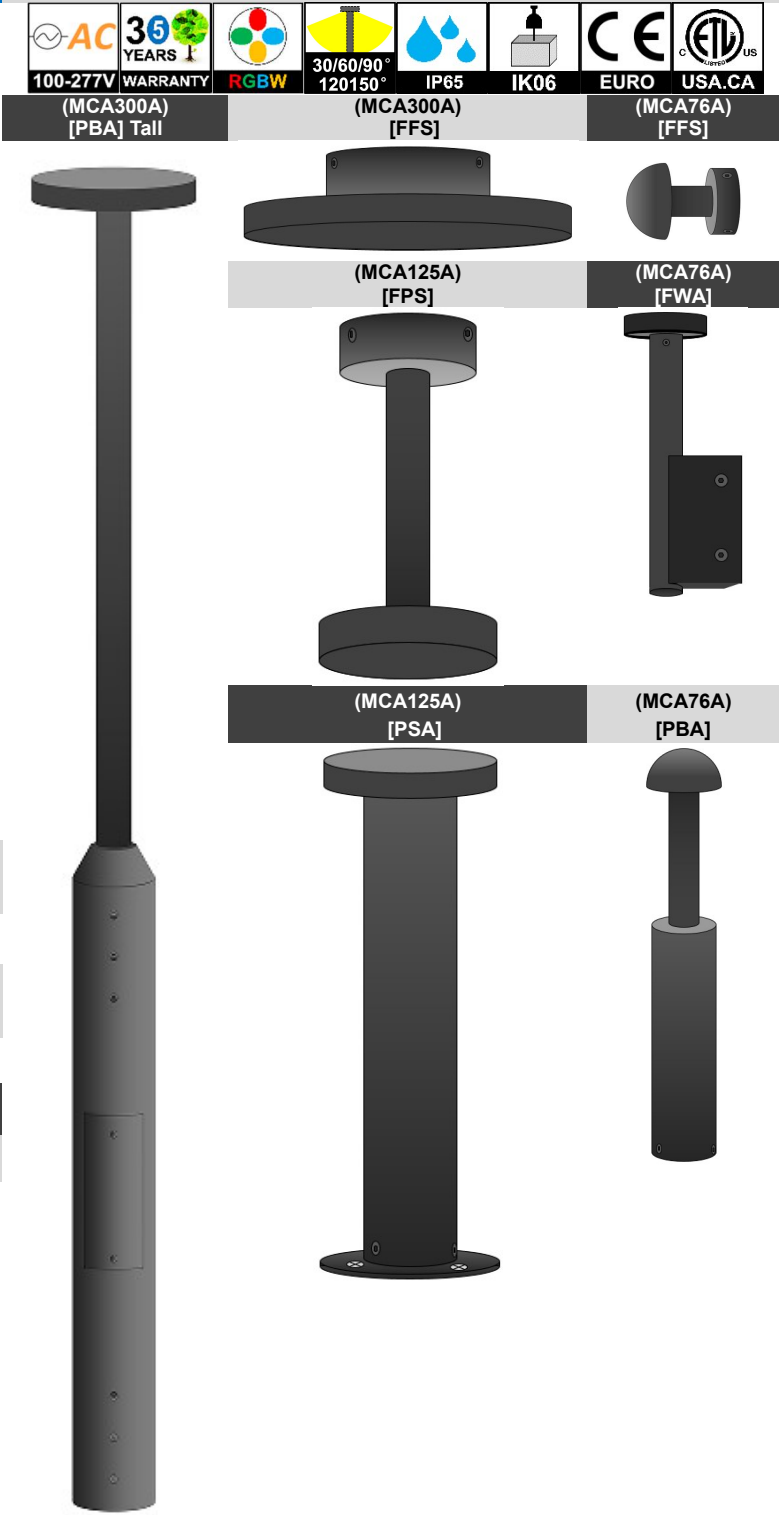

SPECIFICATION **ERMA: LED GARDEN LIGHT**

MODEL	POWER [W]	LED TYPE	CCT [K]	CRI	FLUX [LM]	POWER FACTOR	BEAM ANGLE	CUSTOM DIMMING	INPUT [V]
ERMA-MCA76A	6W [3W]	6x2W SMD3030	G2700K	RA90	440	> 0.9			
			G3000K	RA90	460				
			G3500K	RA90	460				
			G4000K	RA90	490				
			G5000K	RA90	490				
			G6500K	RA90	490				
2C@6W	TW	G2700K G6500K	RA90	440	> 0.9				
4C@6W	RGBW	620nm 520nm 460nm 2700K	\	440	> 0.9				
ERMA-MCA76B MCA95A	10W [6W]	12x2W SMD3030	G2700K	RA90	730	> 0.9			
			G3000K	RA90	770				
			G3500K	RA90	770				
			G4000K	RA90	820				
			G5000K	RA90	820				
			G6500K	RA90	820				
2C@10W	TW	G2700K G6500K	RA90	730	> 0.9				
4C@10W	RGBW	620nm 520nm 460nm 2700K	\	730	> 0.9				
ERMA-MCA95B MCA125A	15W [20W] [10W] [6W]	24x2W SMD3030	G2700K	RA90	1010	> 0.9			
			G3000K	RA90	1100				
			G3500K	RA90	1100				
			G4000K	RA90	1140				
			G5000K	RA90	1140				
			G6500K	RA90	1140				
2C@15W	TW	G2700K G6500K	RA90	1010	> 0.9				
4C@15W	RGBW	620nm 520nm 460nm 2700K	\	1010	> 0.9				
ERMA-MCA125B MCA160A	20W [30W] [10W]	24x2W SMD3030	G2700K	RA90	1450	> 0.9			
			G3000K	RA90	1550				
			G3500K	RA90	1550				
			G4000K	RA90	1630				
			G5000K	RA90	1630				
			G6500K	RA90	1630				
2C@20W	TW	G2700K G6500K	RA90	1450	> 0.9				
4C@20W	RGBW	620nm 520nm 460nm 2700K	\	1450	> 0.9				
ERMA-MCA200A	30W [40W] [20W] [12W]	36x2W SMD3030	G2700K	RA90	2180	> 0.9	[Symmetric] BL30D:30° BL60D:60° BL90D:90° BL120D:120°		
			G3000K	RA90	2310				
			G3500K	RA90	2310				
			G4000K	RA90	2450				
			G5000K	RA90	2450				
			G6500K	RA90	2450				
2C@30W	TW	G2700K G6500K	RA90	2180	> 0.9				
4C@30W	RGBW	620nm 520nm 460nm 2700K	\	2180	> 0.9				
ERMA-MCA160B MCA250A	40W [50W] [30W] [20W]	48x2W SMD3030	G2700K	RA90	2910	> 0.9	[Louver] BGL LM-25%		
			G3000K	RA90	3100				
			G3500K	RA90	3100				
			G4000K	RA90	3270				
			G5000K	RA90	3270				
			G6500K	RA90	3270				
2C@40W	TW	G2700K G6500K	RA90	2910	> 0.9				
4C@40W	RGBW	620nm 520nm 460nm 2700K	\	2910	> 0.9				
ERMA-MCA200B MCA300A	50W [60W] [40W] [30W]	60x2W SMD3030	G2700K	RA90	3510	> 0.9			
			G3000K	RA90	3730				
			G3500K	RA90	3730				
			G4000K	RA90	3950				
			G5000K	RA90	3950				
			G6500K	RA90	3950				
2C@50W	TW	G2700K G6500K	RA90	3510	> 0.9				
4C@50W	RGBW	620nm 520nm 460nm 2700K	\	3510	> 0.9				
ERMA-MCA350A	60W [75W] [50W] [40W] [30W]	96x2W SMD3030	G2700K	RA90	4360	> 0.9			
			G3000K	RA90	4630				
			G3500K	RA90	4630				
			G4000K	RA90	4900				
			G5000K	RA90	4900				
			G6500K	RA90	4900				
2C@60W	TW	G2700K G6500K	RA90	4360	> 0.9				
4C@60W	RGBW	620nm 520nm 460nm 2700K	\	4360	> 0.9				
ERMA-MCA300B MCA400A	75W [100W] [50W]	180x2W SMD3030	G2700K	RA90	5260	> 0.9			
			G3000K	RA90	5590				
			G3500K	RA90	5590				
			G4000K	RA90	5920				
			G5000K	RA90	5920				
			G6500K	RA90	5920				
2C@75W	TW	G2700K G6500K	RA90	5260	> 0.9				
4C@75W	RGBW	620nm 520nm 460nm 2700K	\	5260	> 0.9				
ERMA-MCA500A MCA500B	120W [150W] [100W] [75W] [50W]	240x2W SMD3030	G2700K	RA90	8710	> 0.9			
			G3000K	RA90	9250				
			G3500K	RA90	9250				
			G4000K	RA90	9800				
			G5000K	RA90	9800				
			G6500K	RA90	9800				
2C@120W	TW	G2700K G6500K	RA90	8710	> 0.9				
4C@120W	RGBW	620nm 520nm 460nm 2700K	\	8710	> 0.9				

[AC100~347V]
[CDN]:Non-dim
[CDT]:TRIAC(10%)
[CDV]:0/1~10V(8%)
[CDV0]:0~10V(1%)
[CDV1]:1~10V(10%)
[CDA]:DALI(1%)

[DC12~48V]
[CDN]:Non-dim
[+CDP]:PWM(1%)
[+CDX]:DMX512(1%)
[+CDS]:SPI(1%)

Following [Sensor]
[CSL]: Photocell Lux Sensor

[CSPD]: Big-level PIR Motion Sensor

[CSMD]: Big-level Microwave Motion Sensor

Following by Remote Driver [Outside Fixture]
[CRZ]:ZIGBEE(1%)
[CRF]:2.4G RF(1%)
[CRB]:Bluetooth(1%)

NOTE:
All parameters are measured at 25°C ambient temperature, 35% humidity experimental environment.
Tolerances of power and luminous flux are ±10%, tolerance of color rendering index is ±5.

DIMENSION:[UNIT: MM] (MCA76A)-[FFS] Flush Surface Mounted Light

NOTES: Remote Mounting LED driver (outside of the fixture).

NOTES: Custom Installation and Accessories Referred to Another Catalogue of Fixing Kits.

CASE STUDY:

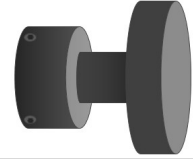
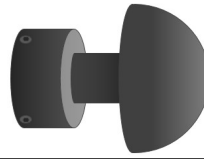
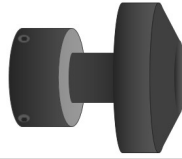
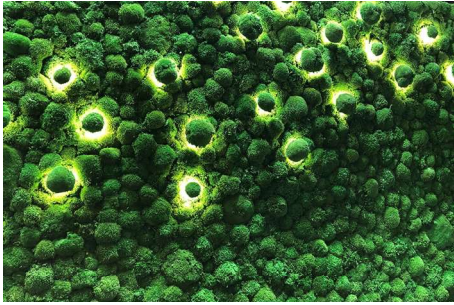

[FFS]-[FBB]-[FNE]

[FFS]-[FBB]-[FNE]

[FFS]-[FBB]-[FNE]

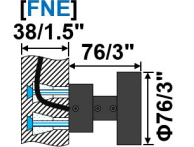
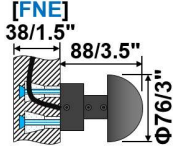
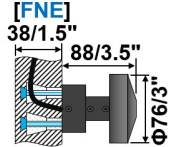

CASE STUDY:

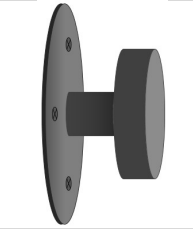
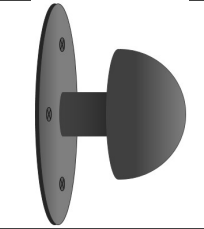
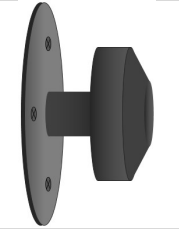

[FFS]-[FJP]

[FFS]-[FJP]

[FFS]-[FJP]

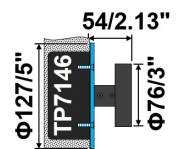
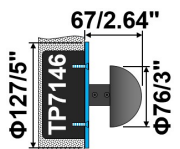
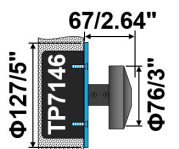

DIMENSION:[UNIT: MM] (MCA95A)-[FFS] Flush Surface Mounted Light

NOTES: Remote Mounting LED driver (outside of the fixture).

NOTES: Custom Installation and Accessories Referred to Another Catalogue of Fixing Kits.

CASE STUDY:

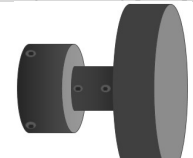
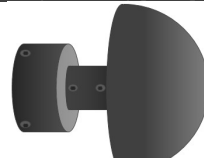
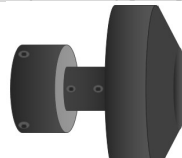
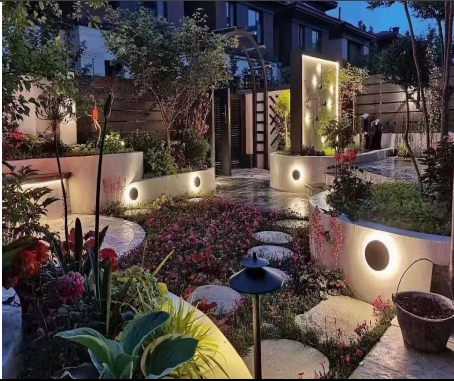

[FFS]-[FBB]-[FNE]

[FFS]-[FBB]-[FNE]

[FFS]-[FBB]-[FNE]

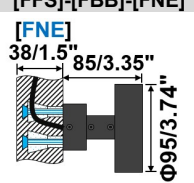
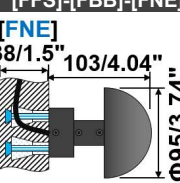
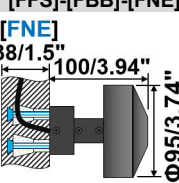

CASE STUDY:

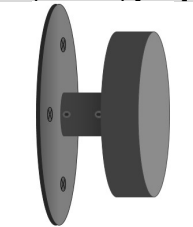
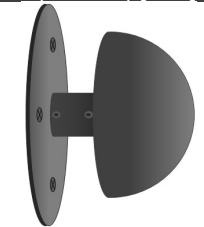
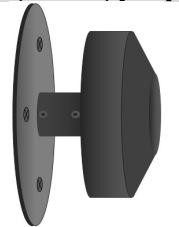

[FFS]-[FJP]

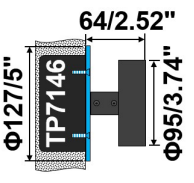
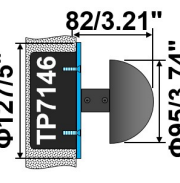
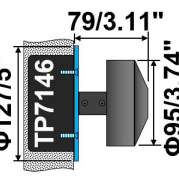

[FFS]-[FJP]

[FFS]-[FJP]



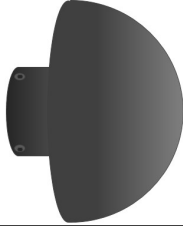
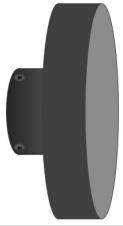
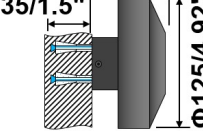
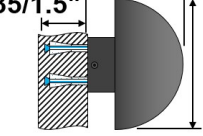
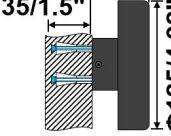

DIMENSION:[UNIT: MM] (MCA125A)-[FFS] Flush Surface Mounted Light

- NOTES: Remote Mounting LED driver (outside of the fixture).
- NOTES: LED driver (≤12W) can be Integrated inside the 4" Jbox.
- NOTES: Custom Installation and Accessories Referred to Another Catalogue of Fixing Kits.

CASE STUDY:	(MCA125A)-[MTT]	(MCA125A)-[MTD]	(MCA125A)-[MTF]
	 <p>[FFS]-[FNE]</p> <p>[FNE] 70/2.76"</p> <p>35/1.5"</p> <p>Φ125/4.92"</p>	 <p>[FFS]-[FNE]</p> <p>[FNE] 88/3.44"</p> <p>35/1.5"</p> <p>Φ125/4.92"</p>	 <p>[FFS]-[FNE]</p> <p>[FNE] 55/2.17"</p> <p>35/1.5"</p> <p>Φ125/4.92"</p>
	 <p>[FFS]-[FJP]</p> <p>74/2.91"</p> <p>Φ127/5"</p> <p>TP7146</p> <p>Φ125/4.92"</p>	 <p>[FFS]-[FJP]</p> <p>92/3.6"</p> <p>Φ127/5"</p> <p>TP7146</p> <p>Φ125/4.92"</p>	 <p>[FFS]-[FJP]</p> <p>59/2.32"</p> <p>Φ127/5"</p> <p>TP7146</p> <p>Φ125/4.92"</p>

DIMENSION:[UNIT: MM] (MCA160A)-[FFS] Flush Surface Mounted Light

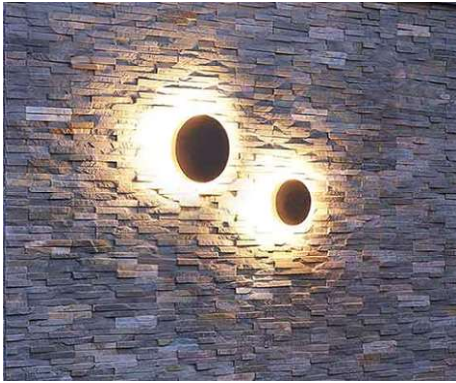
- NOTES: LED driver (≤12W) can be Integrated inside the box. Others needs be Remote Mounting.
- NOTES: Custom Installation and Accessories Referred to Another Catalogue of Fixing Kits.

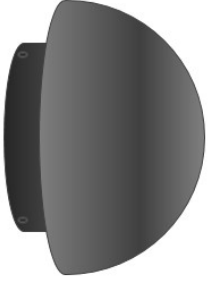
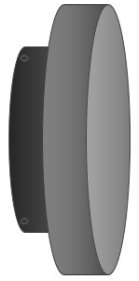
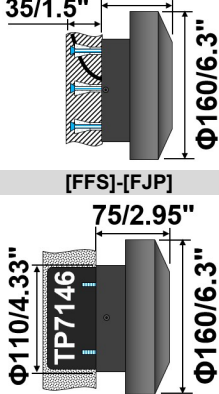
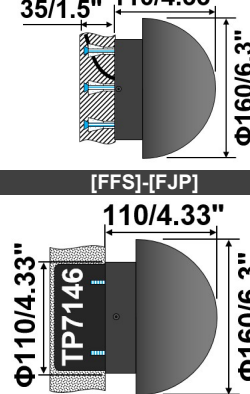
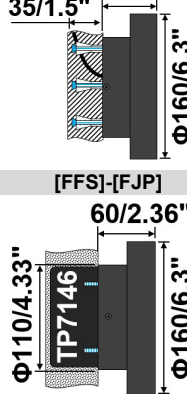
CASE STUDY:	(MCA160A)-[MTT]	(MCA160A)-[MTD]	(MCA160A)-[MTF]
	 <p>[FFS]-[FNE]</p> <p>[FNE] 75/2.95"</p> <p>35/1.5"</p> <p>Φ160/6.3"</p>	 <p>[FFS]-[FNE]</p> <p>[FNE] 110/4.33"</p> <p>35/1.5"</p> <p>Φ160/6.3"</p>	 <p>[FFS]-[FNE]</p> <p>[FNE] 60/2.36"</p> <p>35/1.5"</p> <p>Φ160/6.3"</p>
	 <p>[FFS]-[FJP]</p> <p>75/2.95"</p> <p>Φ110/4.33"</p> <p>TP7146</p> <p>Φ160/6.3"</p>	 <p>[FFS]-[FJP]</p> <p>110/4.33"</p> <p>Φ110/4.33"</p> <p>TP7146</p> <p>Φ160/6.3"</p>	 <p>[FFS]-[FJP]</p> <p>60/2.36"</p> <p>Φ110/4.33"</p> <p>TP7146</p> <p>Φ160/6.3"</p>

DIMENSION:[UNIT: MM] (MCA200A)-[FFS] Flush Surface Mounted Light

NOTES: LED driver (≤30W) can be Integrated inside the box. Others needs be Remote Mounting.

NOTES: Custom Installation and Accessories Referred to Another Catalogue of Fixing Kits.

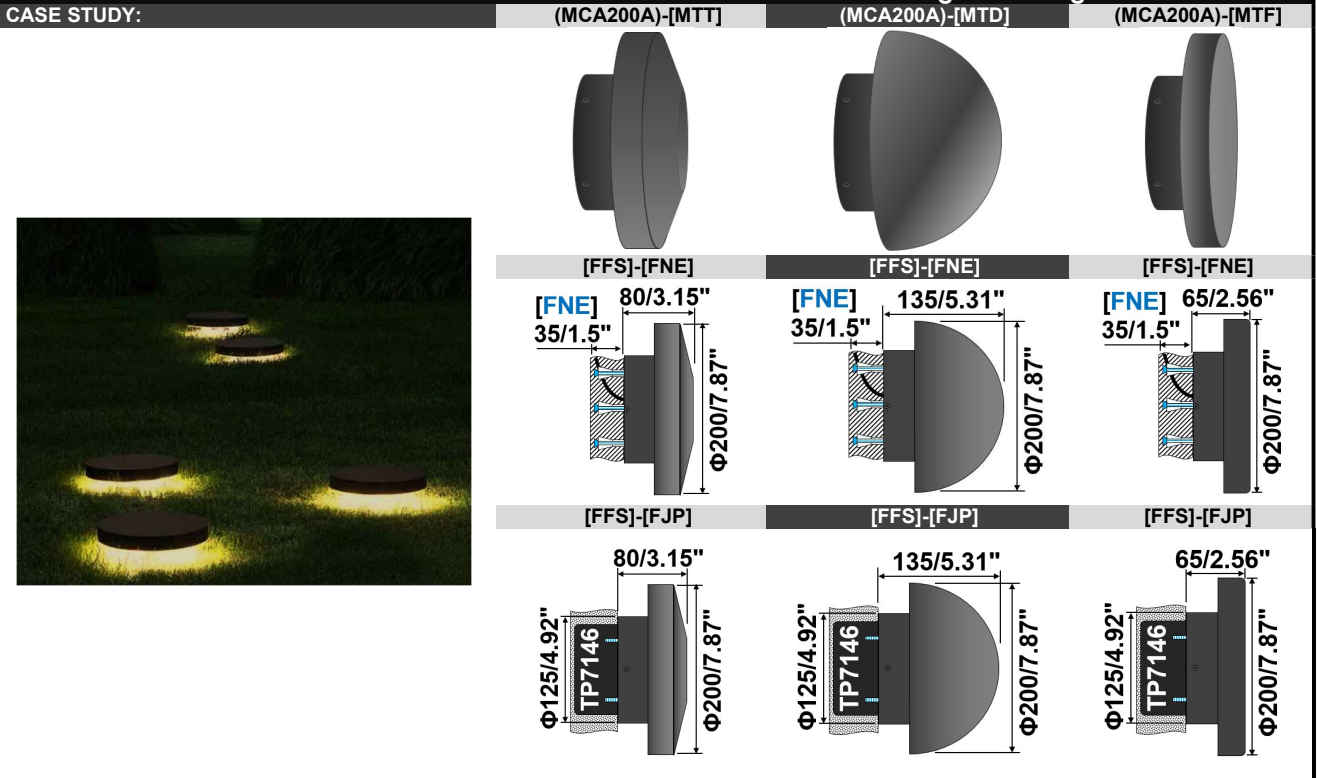

DIMENSION:[UNIT: MM] (MCA250A)-[FFS] Flush Surface Mounted Light

NOTES: LED driver (≤30W) can be Integrated inside the box. Others needs be Remote Mounting.

NOTES: Custom Installation and Accessories Referred to Another Catalogue of Fixing Kits.

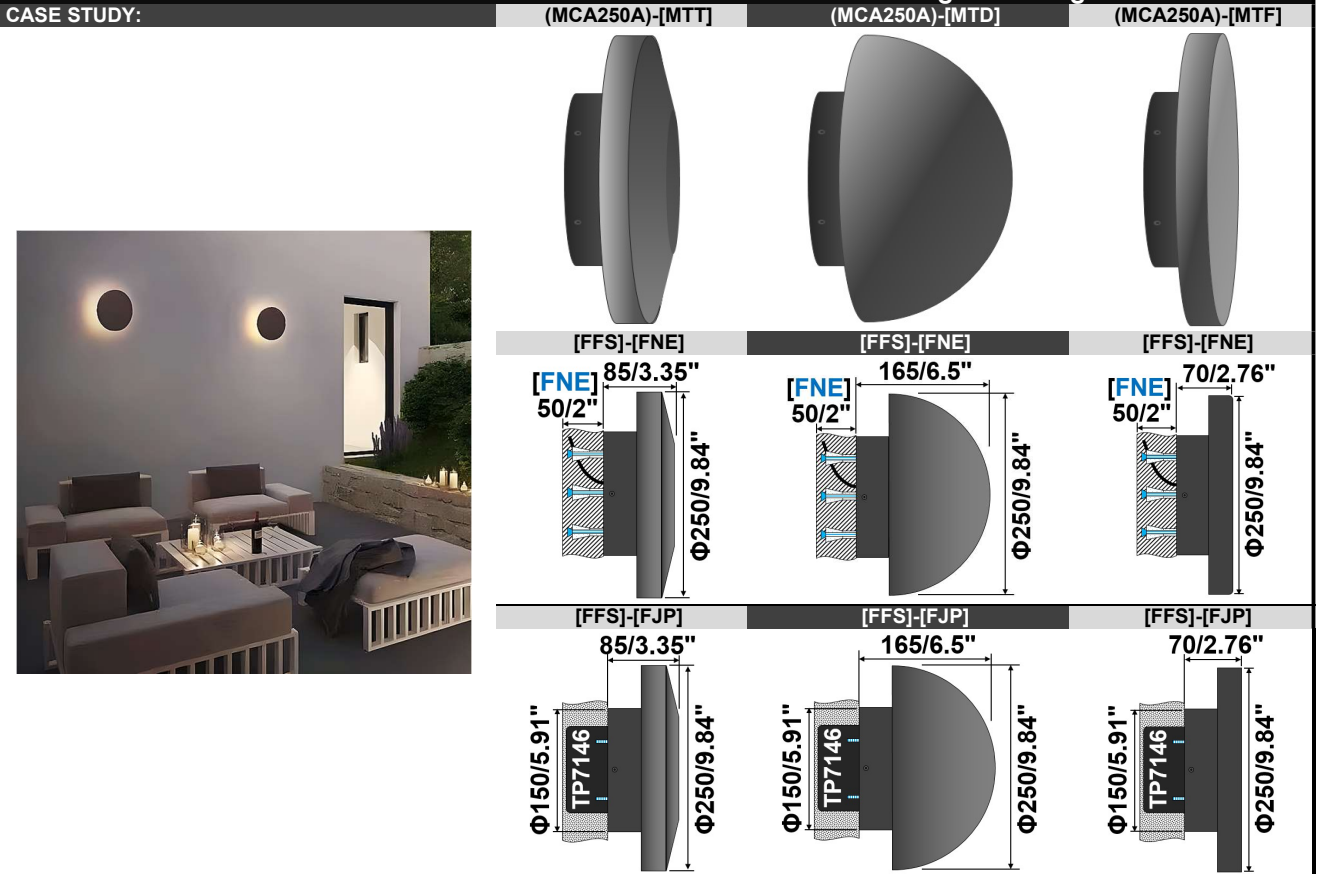

SPECIFICATION

ERMA: LED GARDEN LIGHT

DIMENSION:[UNIT: MM] (MCA300A)-[FFS] Flush Surface Mounted Light
NOTES: LED driver (≤40W) can be Integrated inside the box. Others needs be Remote Mounting.
NOTES: Custom Installation and Accessories Referred to Another Catalogue of Fixing Kits.
CASE STUDY:

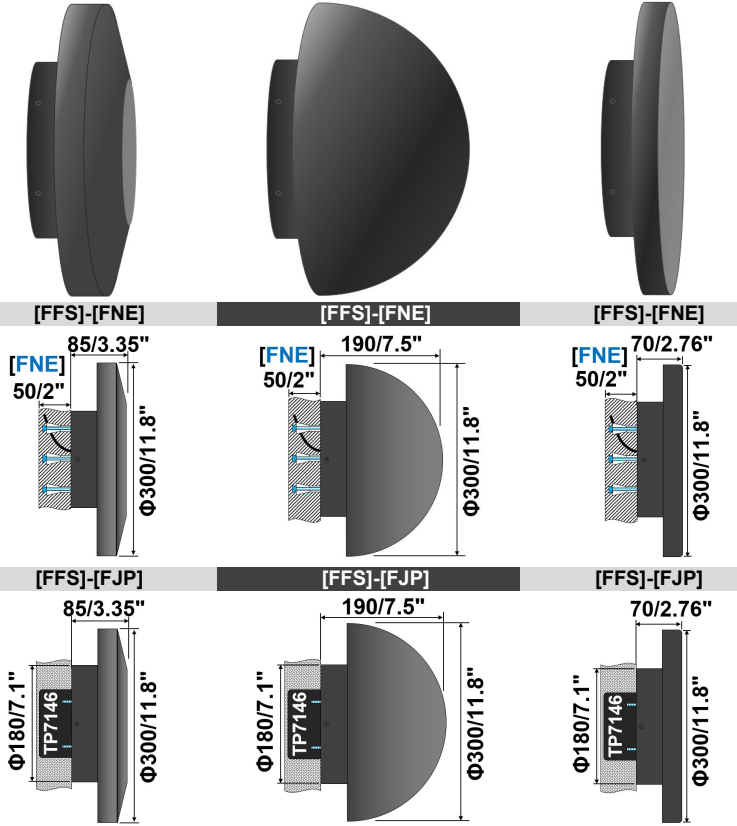

DIMENSION:[UNIT: MM] (MCA350A)-[FFS] Flush Surface Mounted Light
NOTES: LED driver (≤50W) can be Integrated inside the box. Others needs be Remote Mounting.
NOTES: Custom Installation and Accessories Referred to Another Catalogue of Fixing Kits.
CASE STUDY:

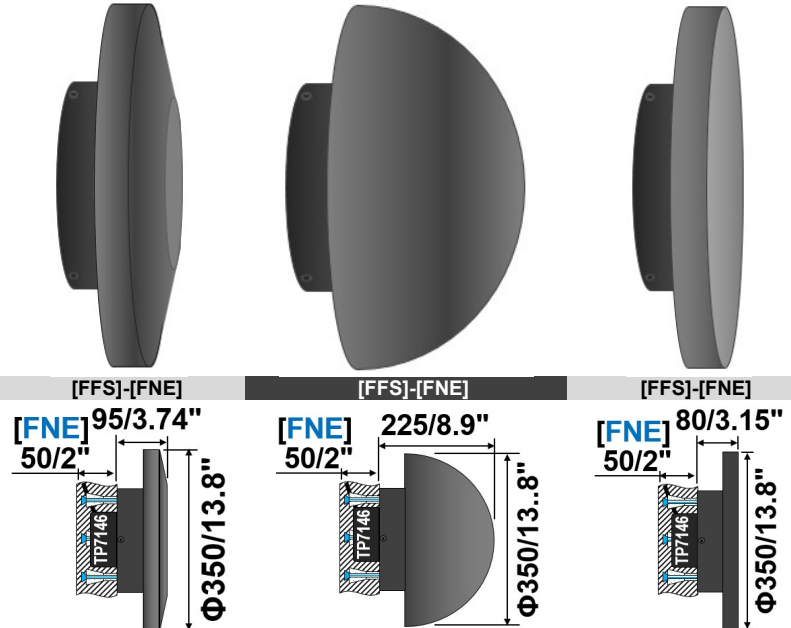

DIMENSION:[UNIT: MM] (MCA76A)-[FWA] Wall Surface Mounted Light

NOTES: Custom Installation and Accessories Referred to Another Catalogue of Fixing Kits.

CASE STUDY:

[FWA]-[FJP]

[FWA]-[FNE]

(MCA76A)-[MTF]

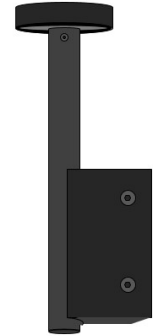
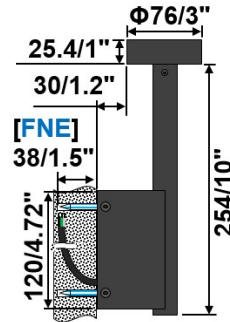
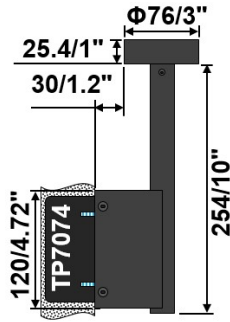

CASE STUDY:

[FWA]-[FJP]

[FWA]-[FNE]

(MCA76B)-[MTF]

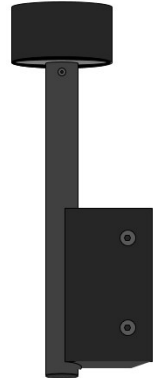
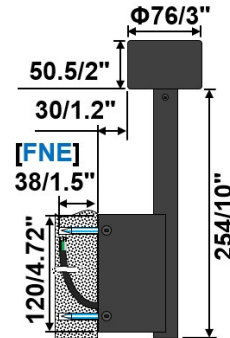
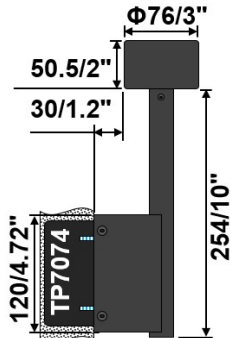

CASE STUDY:

[FWA]-[FJP]

[FWA]-[FNE]

(MCA76A)-[MTD]

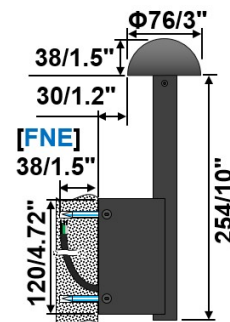
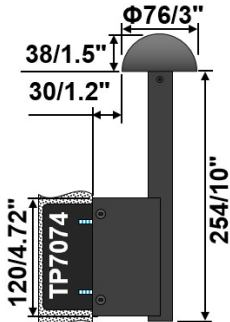
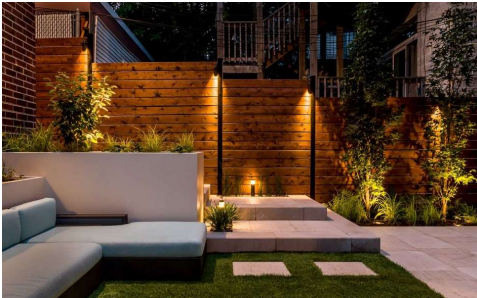

CASE STUDY:

[FWA]-[FJP]

[FWA]-[FNE]

(MCA76A)-[MTT]

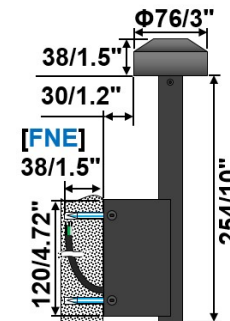
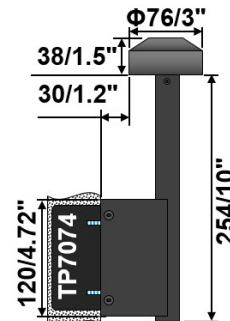

DIMENSION:[UNIT: MM]		(MCA95A)-[FWA] Wall Surface Mounted Light		
NOTES: Custom Installation and Accessories Referred to Another Catalogue of Fixing Kits.				
CASE STUDY:	[FWA]-[FJP]	[FWA]-[FNE]	[FWA]-[FNE]	(MCA95A)-[MTF]
CASE STUDY:	[FWA]-[FJP]	[FWA]-[FNE]	[FWA]-[FNE]	(MCA95B)-[MTF]
CASE STUDY:	[FWA]-[FJP]	[FWA]-[FNE]	[FWA]-[FNE]	(MCA95A)-[MTD]
CASE STUDY:	[FWA]-[FJP]	[FWA]-[FNE]	[FWA]-[FNE]	(MCA95A)-[MTT]

DIMENSION:[UNIT: MM]		(MCA125A)-[FWA] Wall Surface Mounted Light		
NOTES: Custom Installation and Accessories Referred to Another Catalogue of Fixing Kits.				
CASE STUDY:	[FWA]-[FJP]	[FWA]-[FNE]	[FWA]-[FNE]	(MCA125A)-[MTF]
CASE STUDY:	[FWA]-[FJP]	[FWA]-[FNE]	[FWA]-[FNE]	(MCA125B)-[MTF]
CASE STUDY:	[FWA]-[FJP]	[FWA]-[FNE]	[FWA]-[FNE]	(MCA125A)-[MTD]
CASE STUDY:	[FWA]-[FJP]	[FWA]-[FNE]	[FWA]-[FNE]	(MCA125A)-[MTT]

DIMENSION:[UNIT: MM] (MCA160A)-[FWA] Wall Surface Mounted Light

NOTES: Custom Installation and Accessories Referred to Another Catalogue of Fixing Kits.

CASE STUDY:	[FWA]-[FJP]	[FWA]-[FNE]	(MCA160A)-[MTF]
CASE STUDY:	[FWA]-[FNA]	[FWA]-[FNE]	(MCA160B)-[MTF]
CASE STUDY:	[FWA]-[FJP]	[FWA]-[FNE]	(MCA160A)-[MTD]
CASE STUDY:	[FWA]-[FJP]	[FWA]-[FNE]	(MCA160A)-[MTT]

DIMENSION:[UNIT: MM] (MCA200A)-[FWA] Wall Surface Mounted Light

NOTES: Custom Installation and Accessories Referred to Another Catalogue of Fixing Kits.

CASE STUDY:	[FWA]-[FNA]	[FWA]-[FNE]	(MCA200A)-[MTF]
CASE STUDY:	[FWA]-[FNA]	[FWA]-[FNE]	(MCA200B)-[MTF]
CASE STUDY:	[FWA]-[FNA]	[FWA]-[FNE]	(MCA200A)-[MTD]
CASE STUDY:	[FWA]-[FNA]	[FWA]-[FNE]	(MCA200A)-[MTT]

DIMENSION:[UNIT: MM] (MCA76A)-[PBA] BOLLARD Light

NOTES: Custom Installation and Accessories Referred to Another Catalogue of Fixing Kits.

NOTES: Total Height of Poles need be lower than 1600mm/63"

NOTES: When "PB-L76mm" the led driver need be remote outside the bollard.

CASE STUDY:

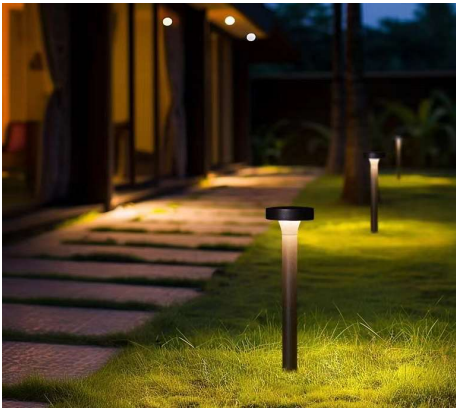

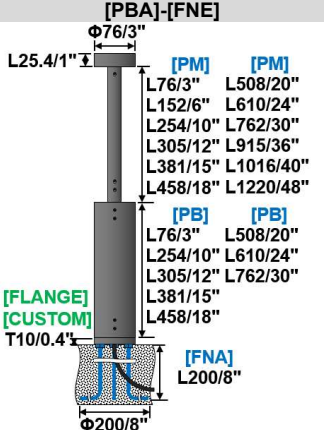
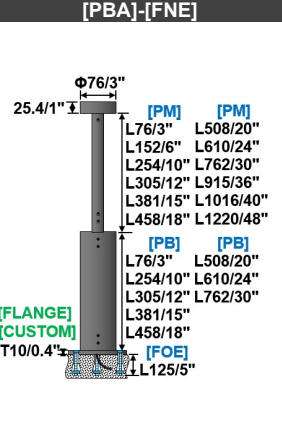
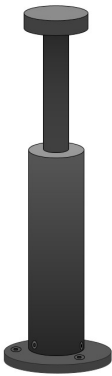
[PBA]-[FNE]	[PBA]-[FNE]	(MCA76A)-[MTF]
		

DIMENSION:[UNIT: MM] (MCA76A)-[PBA] BOLLARD Light

NOTES: Custom Installation and Accessories Referred to Another Catalogue of Fixing Kits.

NOTES: Total Height of Poles need be lower than 1600mm/63"

NOTES: When "PB-L76mm" the led driver need be remote outside the bollard.

CASE STUDY:

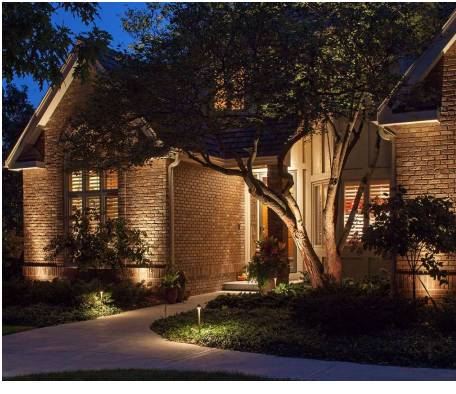

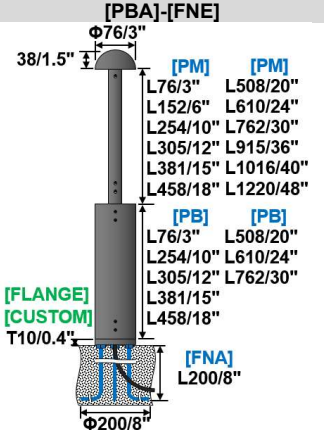
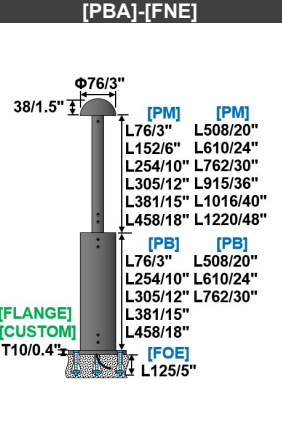
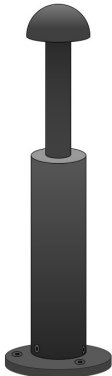
[PBA]-[FNE]	[PBA]-[FNE]	(MCA76A)-[MTD]
		

DIMENSION:[UNIT: MM] (MCA76A)-[PBA] BOLLARD Light

NOTES: Custom Installation and Accessories Referred to Another Catalogue of Fixing Kits.

NOTES: Total Height of Poles need be lower than 1600mm/63"

NOTES: When "PB-L76mm" the led driver need be remote outside the bollard.

CASE STUDY:

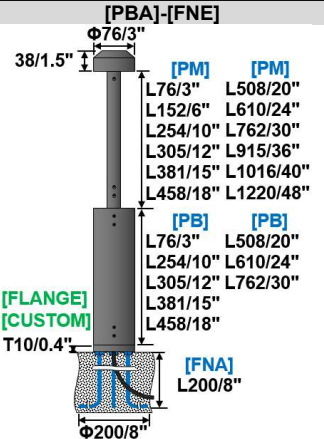
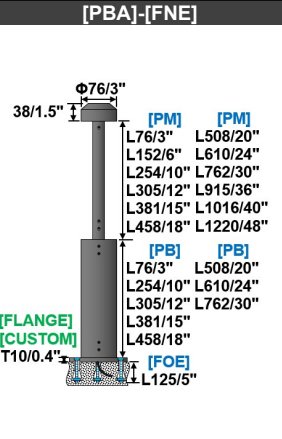
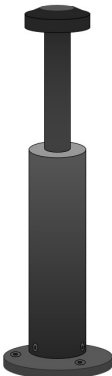

[PBA]-[FNE]	[PBA]-[FNE]	(MCA76A)-[MTT]
		

DIMENSION:[UNIT: MM] (MCA95A)-[PBA] BOLLARD Light

NOTES: Custom Installation and Accessories Referred to Another Catalogue of Fixing Kits.

NOTES: Total Height of Poles need be lower than 1600mm/63"

NOTES: When "PB-L76mm" the led driver need be remote outside the bollard.

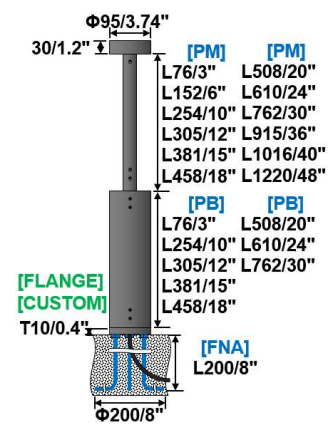
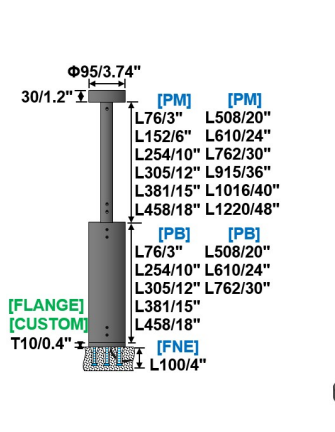
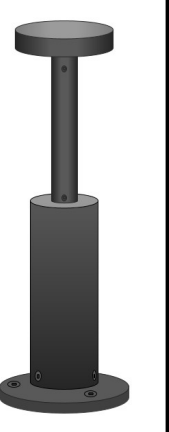
CASE STUDY:	[PBA]-[FNE]	[PBA]-[FNE]	(MCA95A)-[MTF]
			

DIMENSION:[UNIT: MM] (MCA95A)-[PBA] BOLLARD Light

NOTES: Custom Installation and Accessories Referred to Another Catalogue of Fixing Kits.

NOTES: Total Height of Poles need be lower than 1600mm/63"

NOTES: When "PB-L76mm" the led driver need be remote outside the bollard.

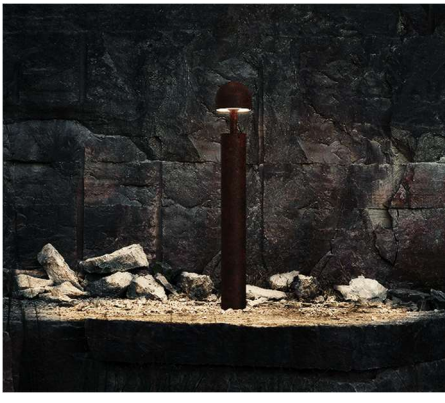
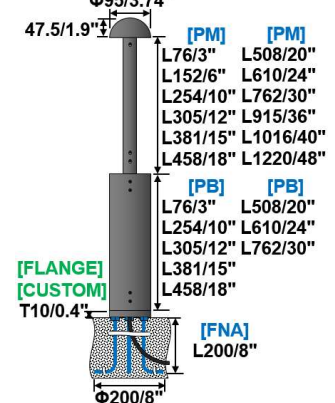
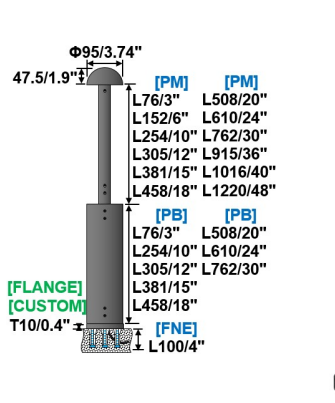
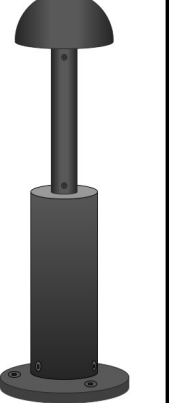
CASE STUDY:	[PBA]-[FNE]	[PBA]-[FNE]	(MCA95A)-[MTD]
			

DIMENSION:[UNIT: MM] (MCA95A)-[PBA] BOLLARD Light

NOTES: Custom Installation and Accessories Referred to Another Catalogue of Fixing Kits.

NOTES: Total Height of Poles need be lower than 1600mm/63"

NOTES: When "PB-L76mm" the led driver need be remote outside the bollard.

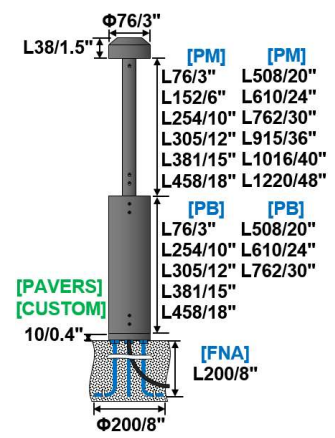
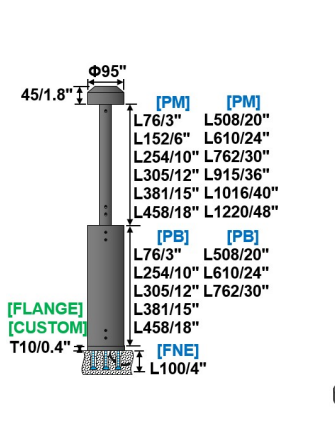
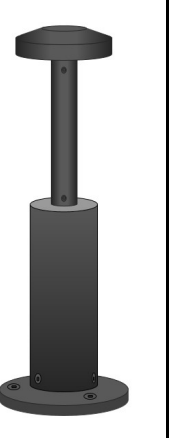
CASE STUDY:	[PBA]-[FNE]	[PBA]-[FNE]	(MCA95A)-[MTT]
			

DIMENSION:[UNIT: MM]

(MCA125A)-[PSA] BOLLARD Light

NOTES: Custom Installation and Accessories Referred to Another Catalogue of Fixing Kits.

CASE STUDY:

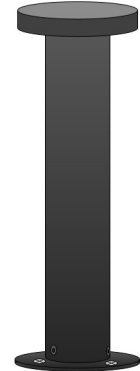
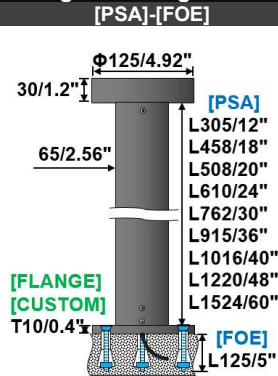
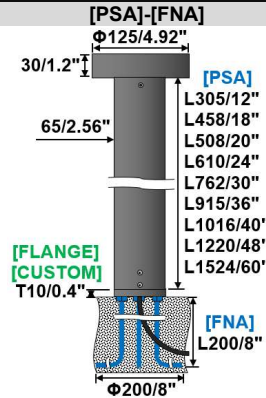

DIMENSION:[UNIT: MM]

(MCA125A)-[PBA] BOLLARD Light

NOTES: Custom Installation and Accessories Referred to Another Catalogue of Fixing Kits.

NOTES: Total Height of Poles need be lower than 1600mm/63"

NOTES: When "PB-L102mm/254mm" the led driver need be remote outside the bollard.

CASE STUDY:

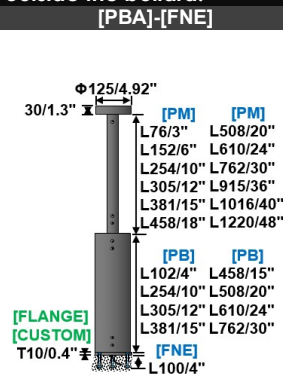
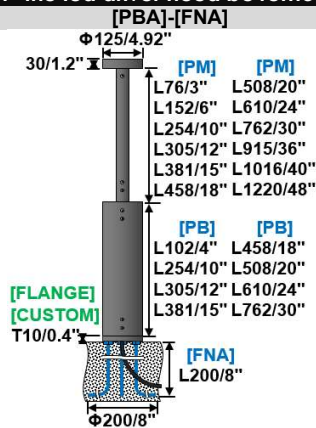

CASE STUDY:

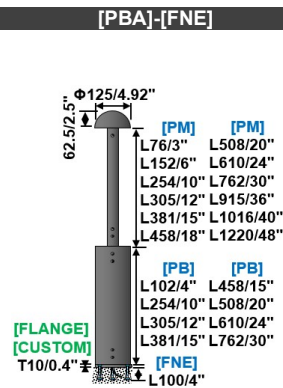
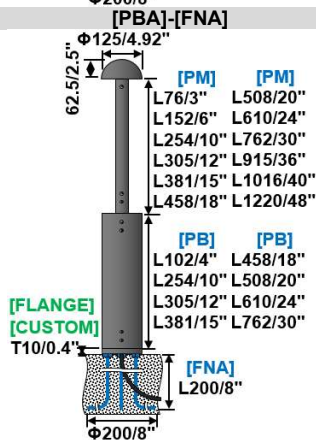

CASE STUDY:

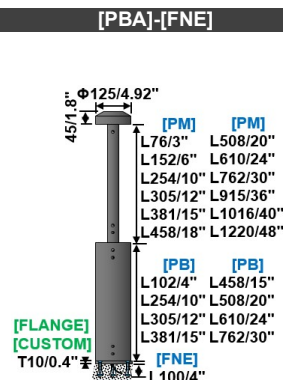
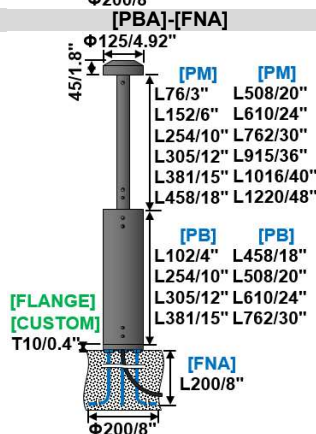

DIMENSION:[UNIT: MM] **(MCA160A)-[PSA] BOLLARD Light**

NOTES: Custom Installation and Accessories Referred to Another Catalogue of Fixing Kits.

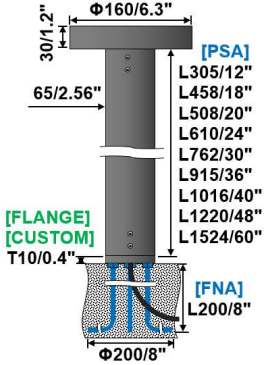
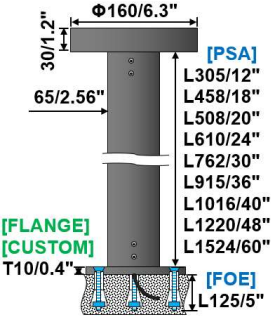
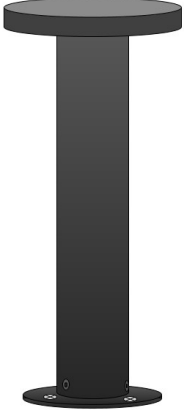

CASE STUDY:	[PSA]-[FNA]	[PSA]-[FOE]	(MCA160A)-[MTF]
			

DIMENSION:[UNIT: MM] **(MCA160A)-[PBA] BOLLARD Light**

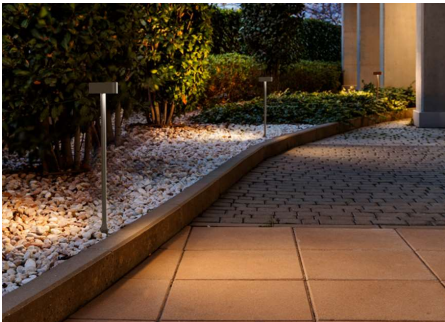
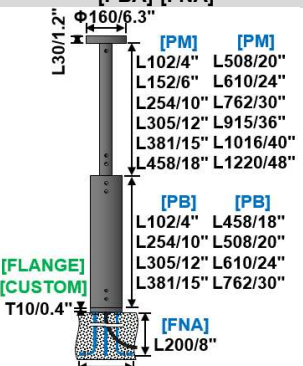
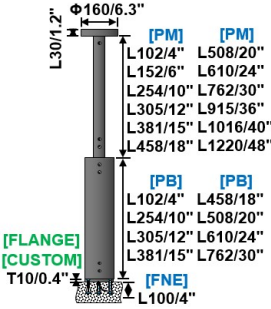

NOTES: Custom Installation and Accessories Referred to Another Catalogue of Fixing Kits.

NOTES: Total Height of Poles need be lower than 1600mm/63"

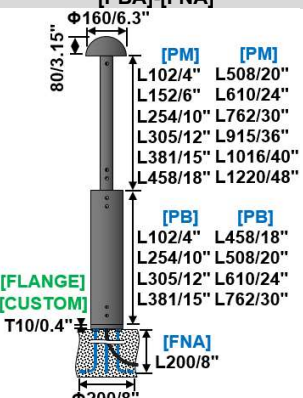
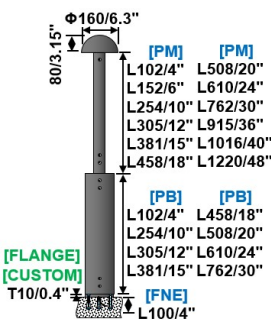

NOTES: When "PB-L102mm/254mm" the led driver need be remote outside the bollard.

CASE STUDY:	[PBA]-[FNA]	[PBA]-[FNE]	(MCA160A)-[MTF]
			

DIMENSION:[UNIT: MM] **(MCA160A)-[MTD]**

CASE STUDY:	[PBA]-[FNA]	[PBA]-[FNE]	(MCA160A)-[MTD]
			

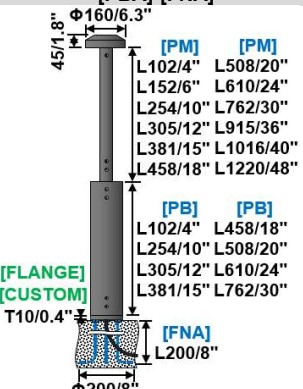
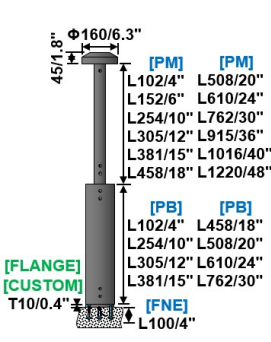
DIMENSION:[UNIT: MM] **(MCA160A)-[MTT]**

CASE STUDY:	[PBA]-[FNA]	[PBA]-[FNE]	(MCA160A)-[MTT]
			

DIMENSION:[UNIT: MM] **(MCA200A)-[PSA] BOLLARD Light**

NOTES: Custom Installation and Accessories Referred to Another Catalogue of Fixing Kits.

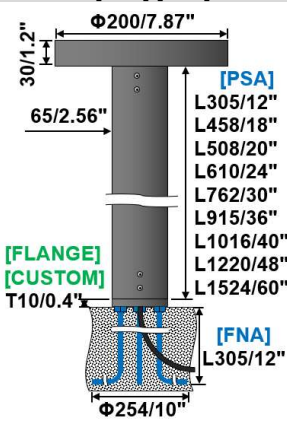
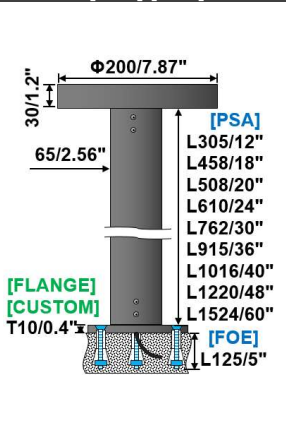
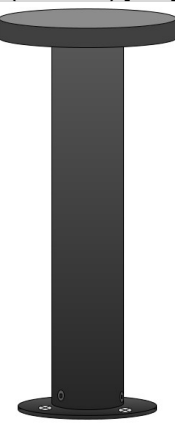
CASE STUDY:	[PSA]-[FNA]	[PSA]-[FOE]	(MCA200A)-[MTF]
			

DIMENSION:[UNIT: MM] **(MCA200A)-[PBA] BOLLARD Light**

NOTES: Custom Installation and Accessories Referred to Another Catalogue of Fixing Kits.

NOTES: Total Height of Poles need be lower than 2000mm/63"

NOTES: When "PB-L102mm/254mm" the led driver need be remote outside the bollard.

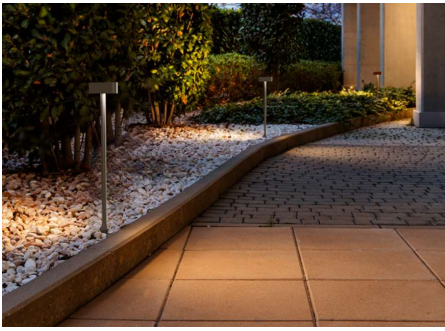
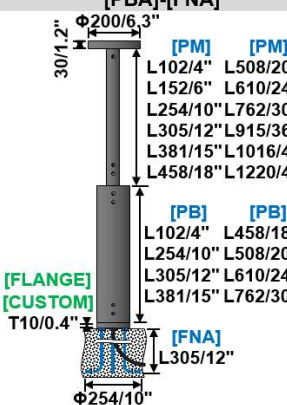
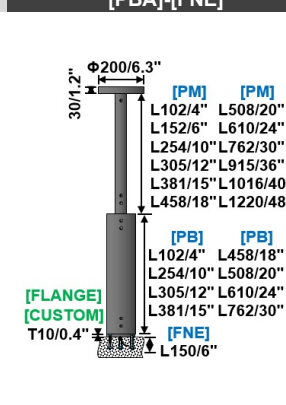
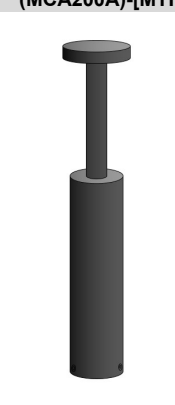
CASE STUDY:	[PBA]-[FNA]	[PBA]-[FNE]	(MCA200A)-[MTF]
			

DIMENSION:[UNIT: MM] **(MCA200A)-[MTD]**

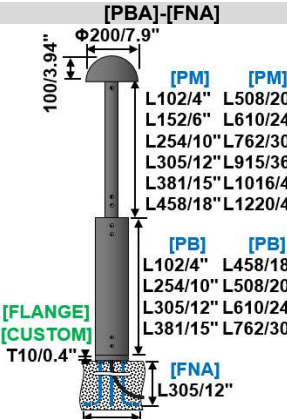
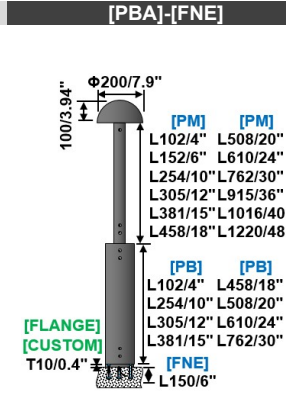
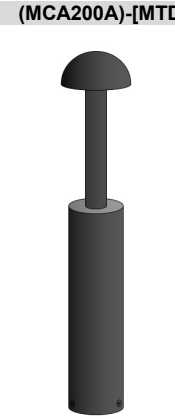
CASE STUDY:	[PBA]-[FNA]	[PBA]-[FNE]	(MCA200A)-[MTD]
			

DIMENSION:[UNIT: MM] **(MCA200A)-[MTT]**

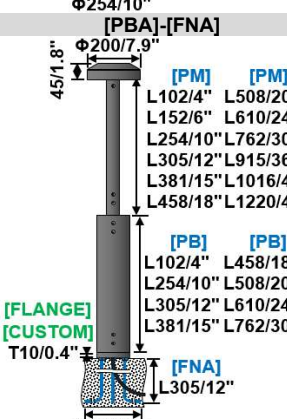
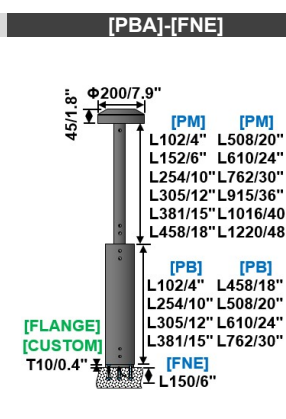
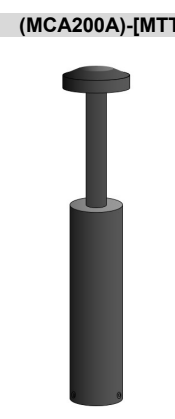
CASE STUDY:	[PBA]-[FNA]	[PBA]-[FNE]	(MCA200A)-[MTT]
			

DIMENSION:[UNIT: MM] **(MCA250A)-[PSA] BOLLARD Light**

NOTES: Custom Installation and Accessories Referred to Another Catalogue of Fixing Kits.

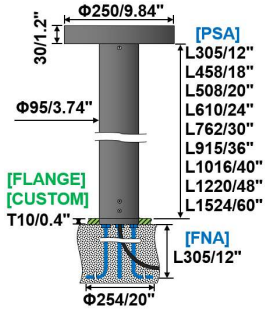
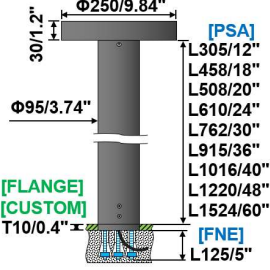
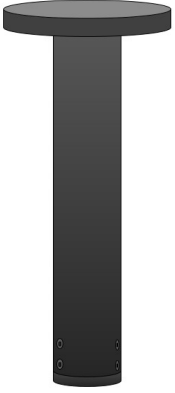
CASE STUDY:	[PSA]-[FNA]	[PSA]-[FNE]	(MCA250A)-[MTF]
	 <p> [PSA] L305/12" L458/18" L508/20" L610/24" L762/30" L915/36" L1016/40" L1220/48" L1524/60" [FNA] L305/12" [FLANGE] [CUSTOM] T10/0.4" [PAVERS] [CUSTOM] 10/0.4" [FNE] L125/5" Φ254/20" </p>	 <p> [PSA] L305/12" L458/18" L508/20" L610/24" L762/30" L915/36" L1016/40" L1220/48" L1524/60" [FNE] L125/5" [FLANGE] [CUSTOM] T10/0.4" </p>	

DIMENSION:[UNIT: MM] **(MCA300A)-[PSA] BOLLARD Light**

NOTES: Custom Installation and Accessories Referred to Another Catalogue of Fixing Kits.

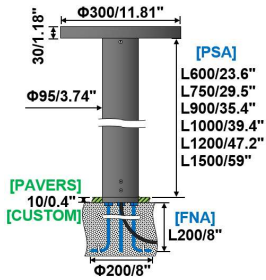
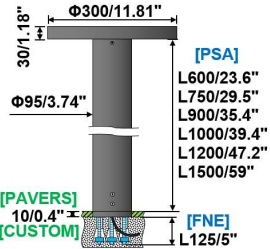
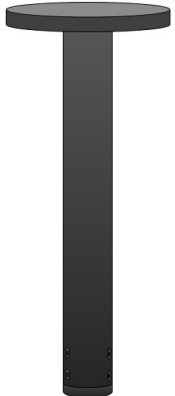
CASE STUDY:	[PSA]-[FNA]	[PSA]-[FNE]	(MCA300A)-[MTF]
	 <p> [PSA] L600/23.6" L750/29.5" L900/35.4" L1000/39.4" L1200/47.2" L1500/59" [FNA] L200/8" [PAVERS] [CUSTOM] 10/0.4" [FNE] L125/5" Φ200/8" </p>	 <p> [PSA] L600/23.6" L750/29.5" L900/35.4" L1000/39.4" L1200/47.2" L1500/59" [FNE] L125/5" [PAVERS] [CUSTOM] 10/0.4" </p>	

DIMENSION:[UNIT: MM] **(MCA500A)-[PSA] BOLLARD Light**

NOTES: Custom Installation and Accessories Referred to Another Catalogue of Fixing Kits.

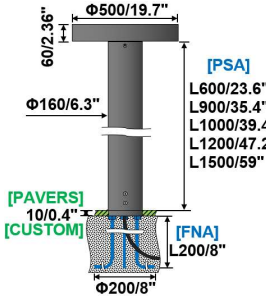
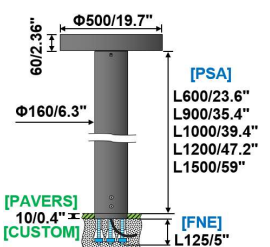
CASE STUDY:	[PSA]-[FNA]	[PSA]-[FNE]	(MCA500A)-[MTF]
	 <p> [PSA] L600/23.6" L900/35.4" L1000/39.4" L1200/47.2" L1500/59" [FNA] L200/8" [PAVERS] [CUSTOM] 10/0.4" [FNE] L125/5" Φ200/8" </p>	 <p> [PSA] L600/23.6" L900/35.4" L1000/39.4" L1200/47.2" L1500/59" [FNE] L125/5" [PAVERS] [CUSTOM] 10/0.4" </p>	